

ISO 13628-8 Class 1-4 (API 17D) Subsea Torque Tool Verification Unit

This unit has been developed to give sub-sea confirmation of torque tool calibration. It consists of a standard class 1-4 torque reaction bucket with a compact torque sensor. To change shafts only one bolt has to be undone.

Torque is displayed on separate universal subsea display unit. The display contains a power on indicator (green LED) and battery low indicator (red LED). The unit can operate continuously for 30 hours, but if no activity is detected after 10 minutes the unit will go into 'sleep' mode and the display will power down, sleep mode can be maintained for up to eight days. The display will 'wake up' as soon as there is a change in signal.



Specifications

Torque Interface:	ISO 13628-8 fig 18 Class 1-4
Maximum Torque:	2,700Nm (2,000ft lbs)
Battery Life:	30 hours permanently on 200 hours in sleep mode (Sleep mode auto on)
Materials:	Aluminium Housing, St St Shafts
Weight (Air/Water):	22/18kg

ISO 13628-8 Class 1-4 (API 17D) Subsea Torque Tool Verification Unit

Part Numbers

A019-958-601

Subsea Verification Unit

A019-958-174

High Torque Tool Adaptor for Verification Unit
(Includes adaptor and 35mm AF Square Shaft)

A019-958-175

Petrobras Torque Tool Adaptor for Verification Unit
(Includes adaptor and 1-3/8"mm AF Hex Shaft)

Features

- ISO 13628-8 Fig 18 (API 17D) Class 1-4
- Max torque 2,700Nm(2,000 ft lbs)
- 4,000 m Rated
- Interchangeable Shafts
- Self Contained Unit
- Rechargeable Battery or ROV power
- Supplied in offshore suitable transit case

What's in the box

- Dual Line USD
- Battery Pack
- Subsea verification Unit
- Battery Charger
- Connection Cables
- PC Calibration Software
- Class 1+2 Shaft
- Class 3 Shaft
- Class 4 Shaft
- Operations & Maintenance Manual

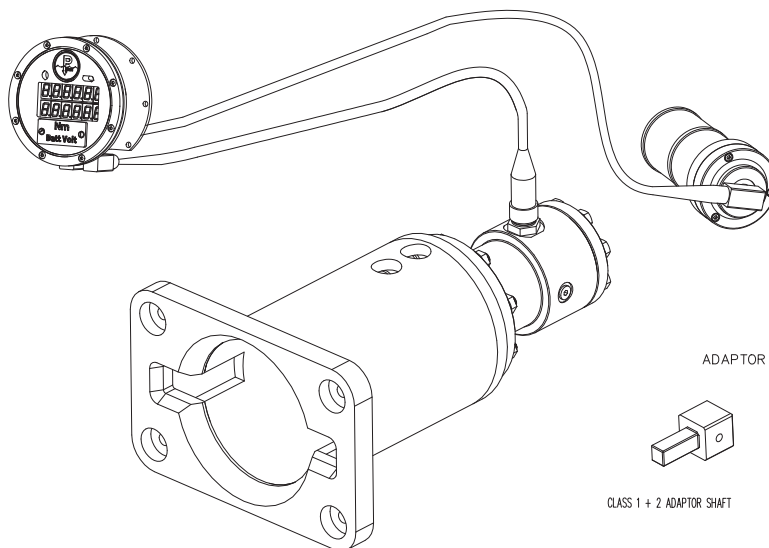

ADAPTOR SHAFTS INCLUDED WITH SYSTEM

