

HP HT Float Equipment

Operators face many challenges with well construction designs in achieving satisfactory zonal isolation during the cementing process. Challenges with high pressure formations requiring heavy mud weights, long horizontal legs utilizing Casing Flotation Tools, and setting the well up for later frac stimulation treatments during the casing running process utilizing Frac Sleeves and Wet Shoe Cementing processes.

Most of these conditions require a need for High Performance Float Valve Equipment that exceeds standard flow and back pressure ratings of standard Composite Float Valves.

Davis-Lynch has the solution for these needs with our 15K Back Pressure Rated 500H Float Shoe and 700H Float Collar.

Design

- 15K Rated Mechanical Poppet Valves fabricated from high strength metallic materials (drillable and non-drillable)
- Special Seal Designs for longer sealing capabilities and valve life expectancies
- Fully Covered Viton Rubber Coated Valve Poppet
- Built to exceed API Spec 10F D24 (24hrs flow)- R10 (10bpm flow rate)- T400 (400 DegF)- P7.5 (7500 psi back pressure)
- API Q1 manufactured with full traceability of all components
- USA Manufactured at our Pearland, Texas Manufacturing Facility
- These heavy-duty valves offer positive sealing regardless of back pressure in vertical, deviated, and horizontal wellbores.

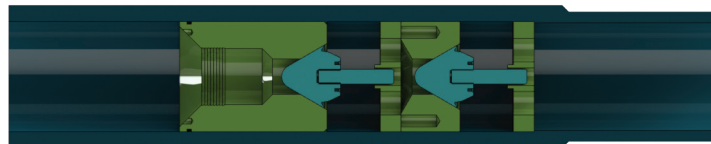

Features

- Available in sizes from 4-1/2" to 7". Other sizes custom built by request
- Available in most Material Grades and Casing Threads
- Available in Aluminum Valves and Seats, Cast-Iron, or CRA Material designs for the most severe service well conditions
- Available in Single and Double Valve Configurations
- 4 Valves Standard in our One-Piece PDQ Wet Shoe Track System
- Numerous Float Shoe Noses available (Composite or Aluminum materials, Rounded, Tapered, Jetted, and with Reamer Blades)
- Float Collar designs available with Latch-in Plug Receptacles for use with matching Latch-in Wiper Plugs

Benefits

- Reliable Top Fill Float Valves for ultimate well control when running casing and preventing casing flow back after primary cementing
- For use with high differential pressures expected at end of Cementing displacements, during Casing Flotation Operations, and Wet Shoe Cementing Process
- Compatible with all mud types (OBM, WBM, SBM)
- Provides ultimate shoe track integrity
- Allows for use with heavy weight muds
- Drillable with PDC bits (excluding Cast Iron or CRA Material valves)