

ALUMINUM COOLERS

 +1 855 446 1155

 f-e-t.com/GHT

 GHT@f-e-t.com



ALUMINUM COOLERS

At FET|GHT, we dedicate ourselves to enhancing our clients' operational and financial efficiency by delivering the most extensive selection of aluminum coolers through our trusted family of radiators and cooling systems.



CANADA-Wide CRN and U.S. ASME Certified

GHT is the only aluminum cooler manufacturer worldwide to achieve Canada-wide CRN certification.

GHT offers ASME-certified coolers in the U.S. that are designed according to ASME 2015 BPVC Section II (materials), VIII (construction), and IX (welding).

Cooler Design

GHT engineers its brazed aluminum coolers to assure operational survivability in transport, static, and operating modes. The cooler dead load is 50/50 glycol water at 75% of the cooler volume plus combined cooler component weights.

GHT engineers its coolers to the following factors:

Transport

- Dead load at 2.5G Vertical Load Factor
- Dead load at 1.6G longitudinal load factor
- Dead load at 1.4G lateral load factor

Static

Dead load plus centered 300-lb. abuse load in the worst-case direction.

Operation

Dead load plus cooler operational load in worst-case direction.

The analysis considers the highest load from each mode, typically transported vertically, to determine cooler survivability from the attached point inward to the critical tank to the core weld.

Temperature Cycle Testing

GHT has done extensive product testing to ensure our coolers perform well in high-temperature applications. GHT tests coolers up to 600°F with no signs of failure.

Pressure Testing

GHT coolers have been third-party burst tested to over 2200 psi — the highest rating in the industry.

Inventory

GHT stocks hundreds of coolers in Edmonton, Houston, and other worldwide locations.

AOX COOLERS

Two Series of Coolers

- 400 Series – 371 to 524 PSI @ 250°F (depending on cooler size)
 - 700 Series – 674 PSI @ 250°F
- » Two circuit cooler.
 - » Great for oil and gas in a single system.
 - » Electric, Hydraulic, and Pneumatic motors available.
 - » Blower and Sucker fan options available.

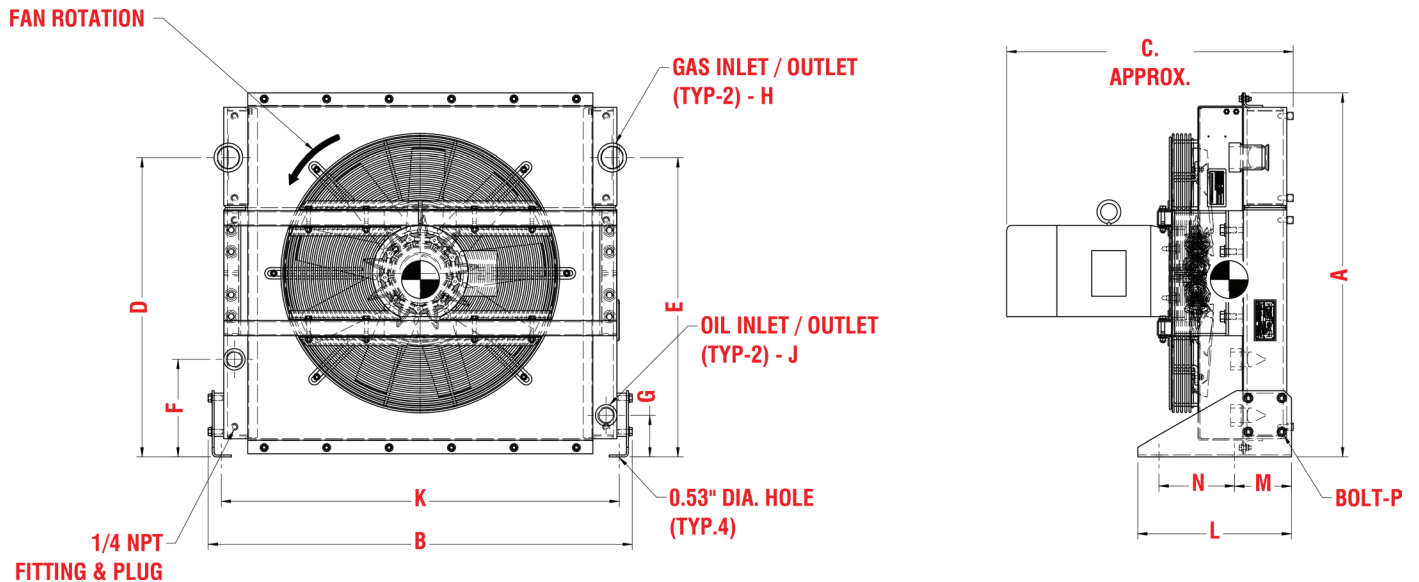

Model Size	DIMENSION (in.)														Weight (lbs) Approx. NET
	A	B	C	D	E	F	G	H (NPT)	J (NPT)	K	L	M	N	P (Bolt)	
AOX 8	12.94	17.28	15.39	11.06	11.06	6.88	3.38	1	0.5	14.5	8.19	3.94	3.5	M8x15	50
AOX 16	16.63	21.88	20.5	14.81	13.63	10.5	3.5	1	1	18.56	8.19	3.94	3.5	M8x15	85
AOX 30	21.31	28.44	21.38	18.88	15.56	10.69	3.88	1.5	1	25.19	9.5	4.56	3.75	M10x15	120
AOX 40	23.31	31.63	21.38	21.19	17.63	14.38	6.44	1.5	1	29.13	9.5	4.56	3.75	M10x15	140
AOX 70	29.69	40.63	26.38	25.38	21.31	13.12	8.12	2	1.25	37.5	16	5.94	7.88	M12x20	210
AOX 100	37.81	44.13	29.63	31.12	31.12	10.12	4.31	2	1.25	41.44	16	5.94	7.88	M12x20	385
AOX 130	38.94	47.19	35	30.88	30.88	9.31	9.31	2.5	1.5	43.38	18	7.94	7.88	M12x20	520
AOX 160	45.88	54.17	35	37.88	34.88	12.5	9.38	3	2	49.31	18	7.94	7.88	M12x20	615
AOX 250	59.38	57.25	36.88	52	43.88	17.75	17.75	3	2	50.55	20	7.91	10	5/8" UNC	810

Chart is for illustration purposes only and should only be used as a guide. Please confirm your selection with a GHT representative.

AX COOLERS

Two Series of Coolers

- 400 Series – 371 to 524 PSI @ 250°F (depending on cooler size)
- 700 Series – 674 PSI @ 250°F

- » Single circuit cooler.
- » Great for remote oil or glycol cooling.
- » Electric, Hydraulic, and Pneumatic motors available.
- » Blower and Sucker fan options available.

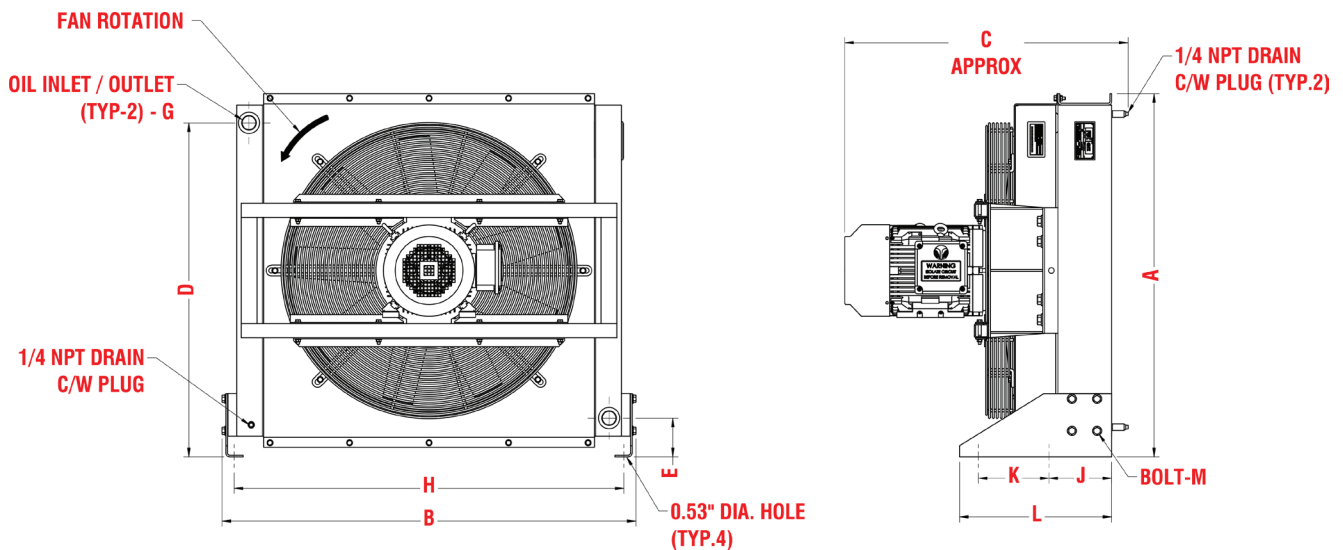
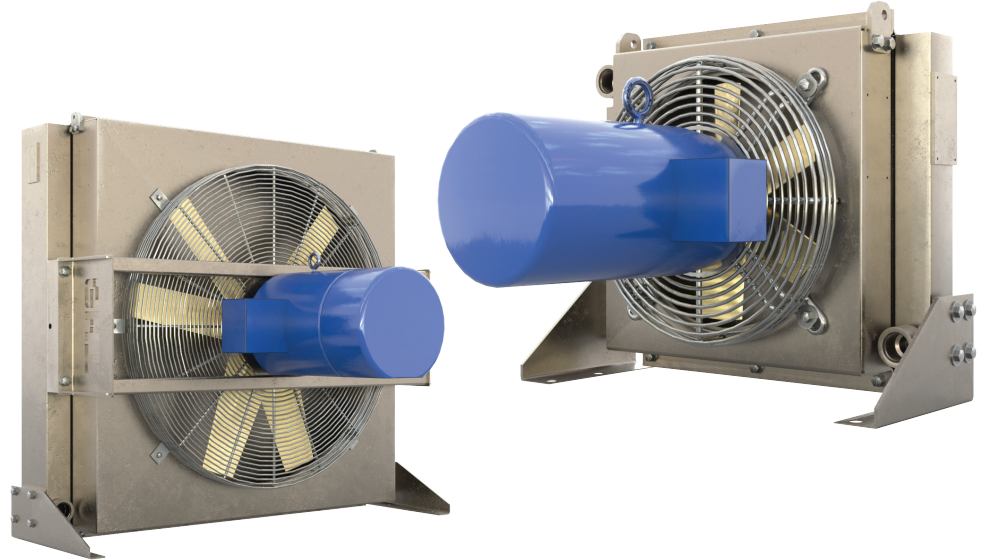

Model Size	DIMENSION (in.)											Weight (lbs) Approx. NET
	A	B	C	D	E	G	H	J	K	L	M (Bolt)	
AX 8	14.64	17.7	15	13.38	2.69	#16 SAE ORB	14.63	4.5	3.5	8.81	M8x20	50
AX 16	18.69	22.44	20.69	16.25	2.94	#16 SAE ORB	18.75	4.5	3.5	8.81	M8x20	70
AX 30	23.13	28.38	21.13	20.56	3.38	#20 SAE ORB	25.25	5.5	3.75	10.38	M10x20	110
AX 40	25	33.1	21.94	22.25	3.38	#20 SAE ORB	29.19	5.5	3.75	10.38	M10x20	140
AX 70	29.5	39.38	28.1	20.63	4.25	#20 SAE ORB	39.38	5.5	7.88	16.13	M12x20	215
AX 100	37.1	54.94	28.56	29.94	4.31	#20 SAE ORB	41.44	5.5	7.88	5	M12x20	330
AX 130	40.5	46.1	35	37.25	4.31	#20 SAE ORB	43.5	7	7.88	17	M12x20	520
AX 160	46.2	52.1	35	42.94	3.5	#24 SAE ORB	49.31	7	7.88	17	M12x20	625
AX 250	58.91	55.17	36.88	55.69	4.06	#24 SAE ORB	50.56	7.81	10	21.5	3/4" UNC	770

Chart is for illustration purposes only and should only be used as a guide. Please confirm your selection with a GHT representative.

CX COOLERS

Two Series of Coolers

- 400 Series – 371 to 524 PSI @ 250°F (depending on cooler size)
 - 700 Series – 674 PSI @ 250°F
- » Single circuit cooler.
 - » Great for remote gas or fluids where low pressure drop is required.
 - » Electric, Hydraulic, and Pneumatic motors available.
 - » Blower and Sucker fan options available.

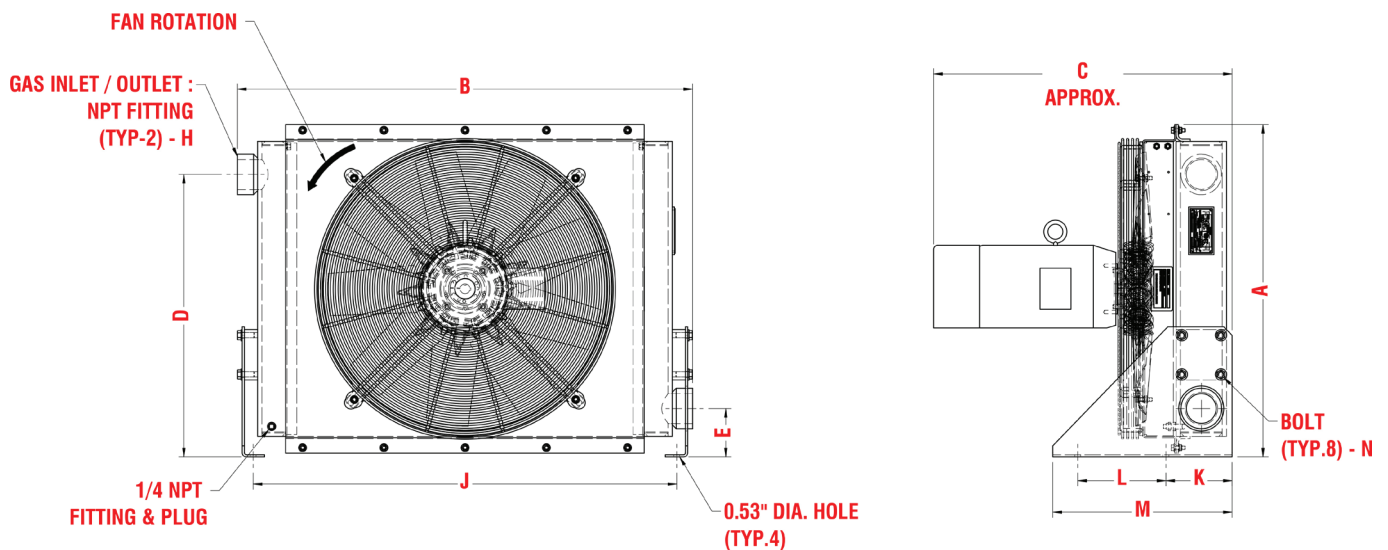
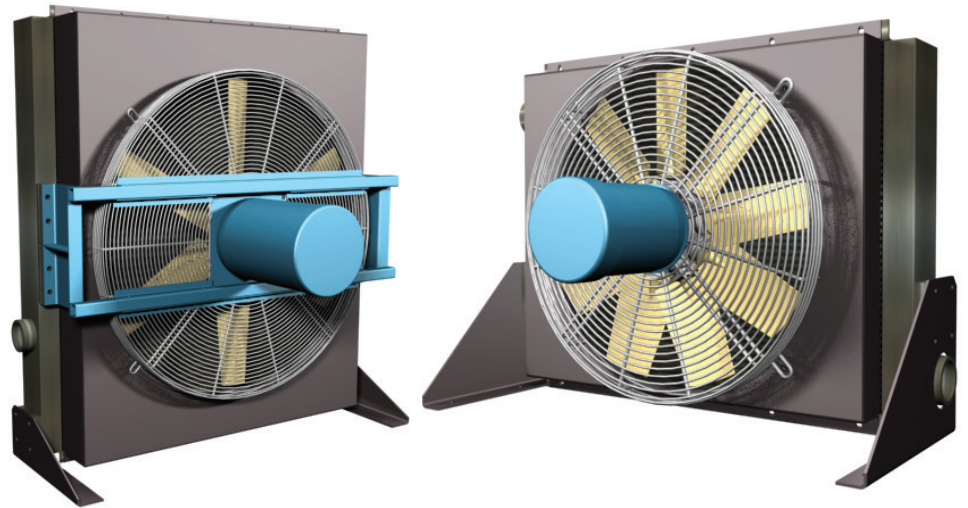

Model Size	DIMENSION (in.)											Weight (lbs) Approx. NET
	A	B	C	D	E	H (NPT)	J	K	L	M	N (Bolt)	
CX 8	12.94	18.31	15.44	10.88	2.5	1	14.63	3.94	3.5	8.79	M8x15	50
CX 16	16.63	23	20.31	14.5	2.5	1.5	18.69	3.94	3.5	8.19	M8x15	85
CX 30	21.31	29.75	21.38	18.81	3.13	2	25.19	4.94	4.5	10.98	M10x15	125
CX 40	23.44	33.69	21.38	21	3.13	2	29.13	4.94	4.5	10.98	M10x15	140
CX 70	29.69	40.63	26.38	25.25	4.31	2.5	37.81	5.94	7.88	16	M12x20	215
CX 100	37.81	45.19	26.56	30.81	4.31	3	41.63	5.94	7.88	16	M12x20	390
CX 130	38.94	47.19	29.19	37.56	10.94	3	43.63	7.94	7.88	18	M12x20	520
CX 160	45.88	53.06	35	34.25	11.56	3	48.81	7.88	7.81	18	M12x20	625
CX 250	59.38	57	36.88	44	17.56	3	57	7.94	10	20	5/8" UNC	805

Chart is for illustration purposes only and should only be used as a guide. Please confirm your selection with a GHT representative.

X COOLERS

Oil Coolers

- Advanced technology design provides compact cooling
- Competitive pricing
- Complete with SAE O-ring connections
- Mounts included
- Working pressure up to 524 PSI* @ 250°F



*MAWP are dependent upon core depth.
Contact GHT for details.

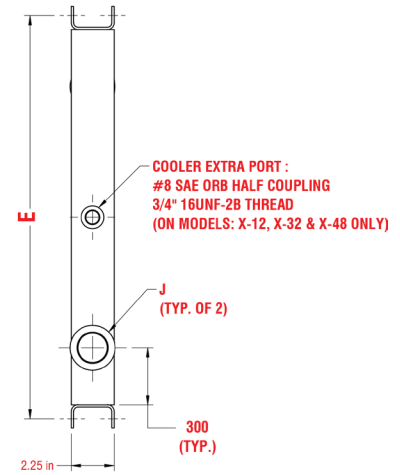
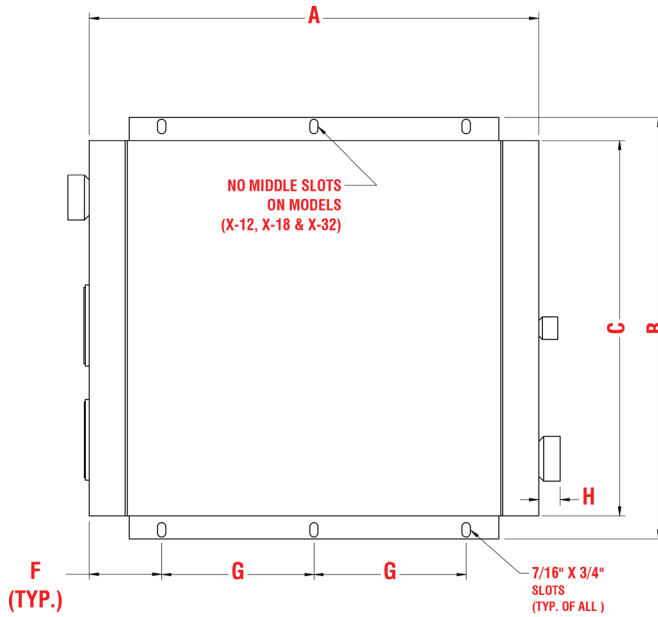

GHT Model	DIMENSION (in.)								Weight (lbs) Approx. NET
	A	B	C	E	F	G	H	J	
X-12	13.98	11.73	9.54	10.87	4.51	4.96	1.00	#12 SAE ORB 1 ¹ / ₁₆ "-12UN-2B THREAD	12
X-18	15.94	13.67	11.46	12.89	5.03	5.87	1.00	#12 SAE ORB 1 ¹ / ₁₆ "-12UN-2B THREAD	16
X-32	19.88	18.43	15.97	17.32	3.94	12.00	1.13	#20 SAE ORB 1 ⁵ / ₈ "-12UN-2B THREAD	26.5
X-48	23.62	22.13	19.71	21.02	3.81	8.00	1.13	#20 SAE ORB 1 ⁵ / ₈ "-12UN-2B THREAD	38
X-66	27.56	25.83	23.33	24.72	3.78	10.00	1.13	#20 SAE ORB 1 ⁵ / ₈ "-12UN-2B THREAD	51
X-82	31.50	27.68	25.18	26.57	5.75	10.00	1.00	#24 SAE ORB 1 ⁷ / ₈ "-12UN-2B THREAD	62
X-120	31.50	39.49	36.99	38.39	5.75	10.00	1.00	#24 SAE ORB 1 ⁷ / ₈ "-12UN-2B THREAD	89

Charts are for illustration purposes only and should only be used as a guide. Please confirm your selection with a GHT representative.

X COOLERS

Oil Coolers

- Advanced technology design provides compact cooling
- Competitive pricing
- Complete with SAE O-ring connections
- Mounts included
- Working pressure up to 524 PSI* @ 250°F



*MAWP are dependent upon core depth. Contact GHT for details.

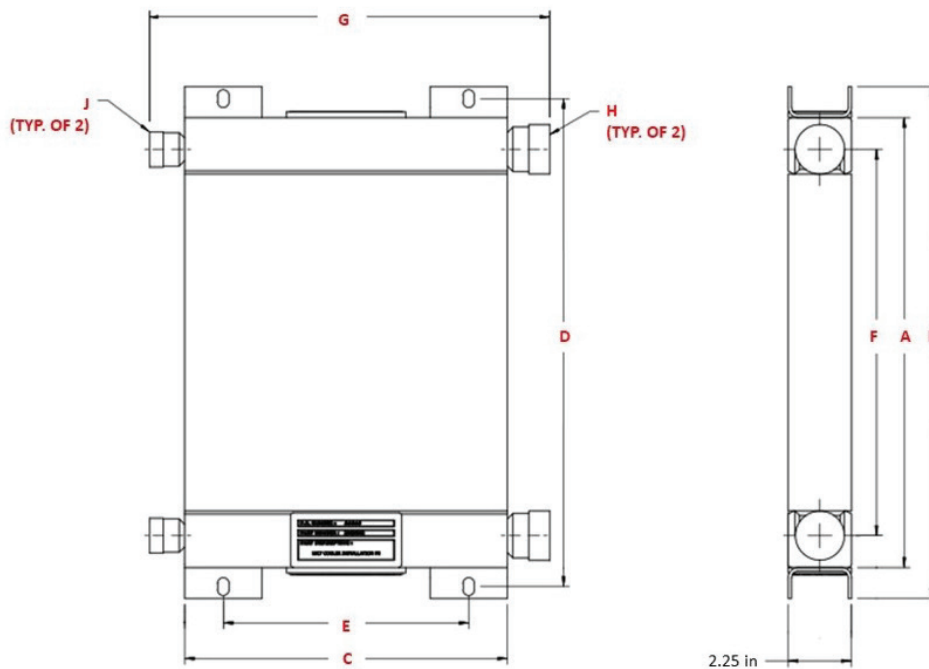

GHT Model	DIMENSION (in.)									Weight (lbs) Approx. NET
	A	B	C	D	E	F	G	H	J	
X-13	13.98	16.42	9.54	15.33	7.54	11.73	11.54	#12 SAE ORB 1 ¹ / ₁₆ "-12UN-2B THREAD	#8 SAE ORB 3/4"-16UNF-2B THREAD	12
X-19	15.94	18.15	11.46	17.29	8.71	13.69	13.46	#12 SAE ORB 1 ¹ / ₁₆ "-12UN-2B THREAD	#8 SAE ORB 3/4"-16UNF-2B THREAD	15.5
X-33	19.88	22.34	15.97	21.36	12.00	17.63	18.10	#20 SAE ORB 1 ⁵ / ₈ "-12UN-2B THREAD	#8 SAE ORB 3/4"-16UNF-2B THREAD	26
X-49	23.62	26.04	19.71	25.08	8 (3 Slots)	21.37	21.84	#20 SAE ORB 1 ⁵ / ₈ "-12UN-2B THREAD	#8 SAE ORB 3/4"-16UNF-2B THREAD	38
X-67	27.56	30.06	23.33	29.06	20.33	25.31	25.46	#20 SAE ORB 1 ⁵ / ₈ "-12UN-2B THREAD	#8 SAE ORB 3/4"-16UNF-2B THREAD	47.5
X-83	31.50	34.00	25.18	33.00	22.18	29.25	27.31	#24 SAE ORB 1 ⁷ / ₈ "-12UN-2B THREAD	#8 SAE ORB 3/4"-16UNF-2B THREAD	60.6
X-121	31.50	34.00	36.99	33.00	33.99	29.25	39.12	#24 SAE ORB 1 ⁷ / ₈ "-12UN-2B THREAD	#8 SAE ORB 3/4"-16UNF-2B THREAD	87

Charts are for illustration purposes only and should only be used as a guide. Please confirm your selection with a GHT representative.



OUR CORE VALUES

No One Gets Hurt

The safety of our employees and customers is our first priority coupled with a healthy respect for the environment.

Integrity

In everything we do, in every interaction, both internally and externally, we strive to operate with the utmost integrity and mutual respect.

Customer Focused

Our products enhance our customer's performance and we listen to their needs and work with them to solve their challenges.

Good Place To Work

We are committed to creating a workplace that fosters innovation, teamwork and pride. Every team member is integral to our success and is treated equally and fairly.

FET | Global Heat Transfer (U.S.)

 14446 Smith Road
Humble, TX 77396

 +1 855 446 1155

FET | Global Heat Transfer (CANADA)

 4755 Eleniak Road
Edmonton, AB T6B-2N1

 +1 780 448 3600

FET | Global Heat Transfer (Permian Basin)

 4501 S. County Rd. 1310
Odessa, TX 79765

 +1 432 789 1541

 f-e-t.com/GHT

 GHT@f-e-t.com