

# PBV® SERIES 5312 UNIBODY

## THREADED FLOATING BALL VALVES

+1 281 637 2000

f-e-t.com/PBV

ForumVS.PBV@f-e-t.com



## How to Order, Standards, and Options

### Specifying PBV® Series 5312 Floating Ball Valve Figure Numbers

**Example: 2" S-5312-38-3600-GL-NC** — This number represents a 2" Stainless Steel 5312 Series Cast Unibody Double Reduced Port Floating Ball Valve with Threaded NPT F X F End Connections, Stainless Steel CF8M Body Material and Internal Trim, Glass-Filled PTFE Seats, Graphite/PTFE Seal Material, NACE Compliant with Latch Locking Lever Handle Operator, no modifications.

S	-	53	12	-	38	-	36	00	-	G	L	-	N	C
Body Material		Design	Design/Port		Port End Connection		Body Material	Internal Trim		Seat Material	Seat Material		NACE Option	Operator
C Carbon Steel WCB		53 PVB Cast	12 Unibody Double Reduced Port		38 Threaded NPT Fem. X Fem.		22 Carbon Steel WCB	36 316 Stainless Steel		T Virgin PTFE	L Graphite/PTFE		N NACE	L Standard Lever
S Stainless Steel CF8M					3M Threaded NPT Male X Fem.		36 Stainless Steel CF8M	00 Same as Body		G Glass-Filled PTFE				C Latch Locking Lever
														V Oval Handle

### Manufactured in Strict Conformance with the Following Industry Standards

- ASME B16.34 Valves – Flanged, Threaded, and Welding End
- ASME/ANSI B1.20.1 Pipe Threads
- Canadian Registration Number (CRN) Products Registered in all Provinces and Territories
- ISO 9001 Quality System
- NACE MR0175 2002 Metals for Sulfide stress cracking and stress corrosion cracking resistance in sour oilfield environments



All Series 5312 valves meet API fire-safe standards.

### Standard Features

- 2000 WOG
- 250 psi Saturated Steam Rating
- Unibody Construction
- Investment Cast CF8M Stainless or WCB Carbon Steel Body
- Blowout Proof Stem
- Reinforced PTFE Seats
- Standard 316 Stainless Steel Ball & Stem
- NACE Compliant
- Firesafe to API 607 4th Edition
- Locking Handle

### Available Options

- Oval Handle



## Parts, Dimensions, and Engineering Data

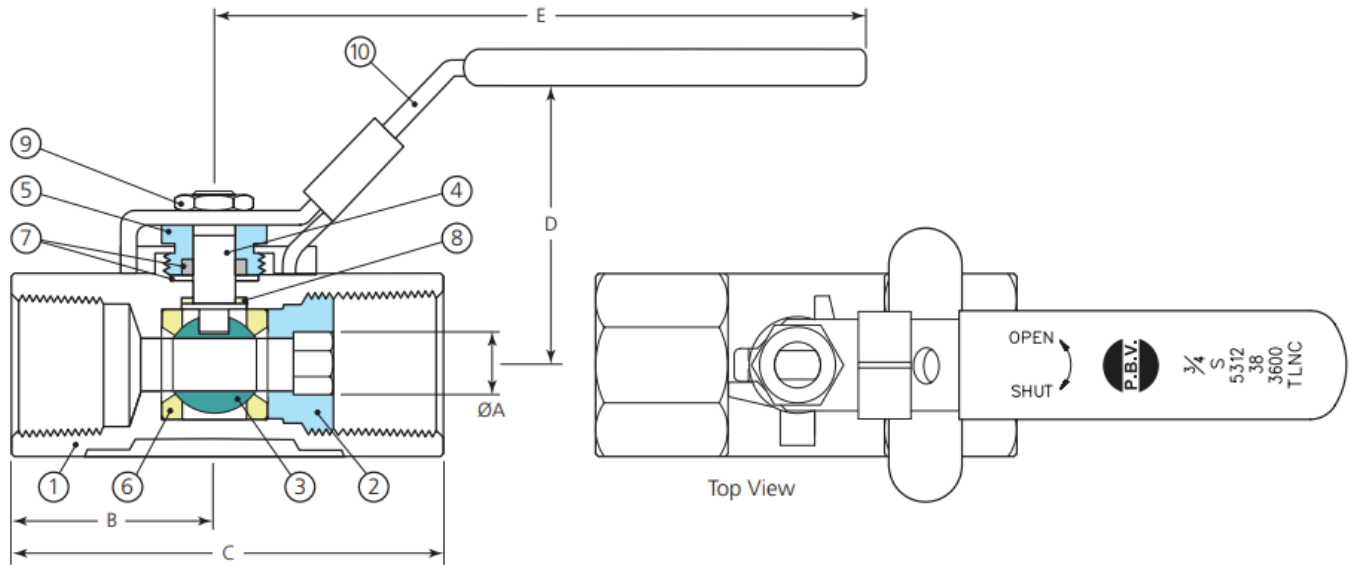

Dimensional Data (in.) and Weight (lbs.) • 1/4" – 2"

Size (in.)	Dimensions (in.)					Weight (lbs.)
	A	B	C	D	E	
1/4	0.31	1.10	2.28	1.97	4.30	0.70
3/8	0.31	1.10	2.28	1.97	4.30	0.70
1/2	0.31	1.20	2.60	1.97	4.30	0.70
3/4	0.47	1.31	2.83	2.20	4.30	1.00
1	0.62	1.50	3.23	2.56	5.75	1.60
1 1/4	0.81	1.65	3.54	2.76	5.75	2.30
1 1/2	1.00	1.85	3.86	3.29	7.40	3.30
2	1.25	2.10	4.33	3.49	7.40	4.70

Note: Weights are approximate.

### Parts & Materials

No.	Qty.	Part Name	Materials	
			Carbon Steel	Stainless Steel
1	1	Body	ASTM A216 WCB	ASTM A351 GR. CF8M
2	1	Tailpiece	AISI 1017 CS	ASTM A276 GR. 316 SS
3	1	Ball	ASTM A276 GR. 316 SS	ASTM A276 GR. 316 SS
4	1	Stem	ASTM A276 GR. 316 SS	ASTM A276 GR. 316 SS
5	1	Packing Nut	ASTM A276 GR. 316 SS	ASTM A276 GR. 316 SS
6	2	Seats	R-PTFE	R-PTFE
7	1	Packing	Graphite	Graphite
8	1	Thrust Washer	R-PTFE	R-PTFE
9	1	Handle Nut	Carbon Steel-Plated	304 Stainless Steel
10	1	Handle Assembly	Carbon Steel-Plated	304 Stainless Steel

### Pressure Temperature

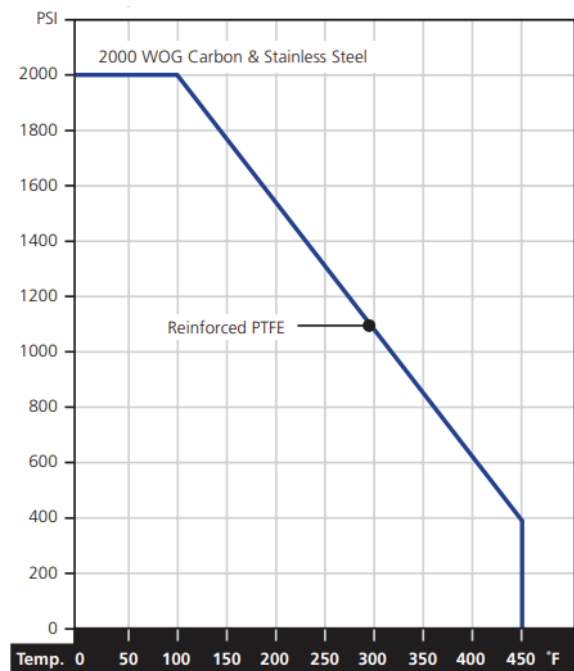

### Break Torques (ft.-lbs.)

Size (in.)						
1/4 – 3/8	1/2	3/4	1	1 1/4	1 1/2	2
60	60	75	150	180	300	400

### Flow Coefficient (Cv)

Size (in.)						
1/4 – 3/8	1/2	3/4	1	1 1/4	1 1/2	2
4.00	4.00	8.00	14.00	19.00	33.00	51.00



## OUR CORE VALUES

### No One Gets Hurt

The safety of our employees and customers is our first priority coupled with a healthy respect for the environment.

### Integrity

In everything we do, in every interaction, both internally and externally, we strive to operate with the utmost integrity and mutual respect.

### Customer Focused

Our products enhance our customer's performance and we listen to their needs and work with them to solve their challenges.

### Good Place To Work

We are committed to creating a workplace that fosters innovation, teamwork and pride. Every team member is integral to our success and is treated equally and fairly.

---

#### FORUM ENERGY TECHNOLOGIES



12735 Dairy Ashford Road  
Stafford, TX 77477



+1 281 637 2000 (General)  
+1 281 637 2097 (Sales)



[f-e-t.com/valve-solutions](http://f-e-t.com/valve-solutions)



[ForumVS.Sales@f-e-t.com](mailto:ForumVS.Sales@f-e-t.com)

The information provided in this brochure is intended for informational purposes only. While we strive to maintain accuracy, please know that the content may change without notification. We do not guarantee the information's completeness, timeliness, or reliability. Any reliance on the content is at your discretion, and we assume no responsibility for errors, omissions, or inaccuracies that may occur.

PBV is a registered trademark of Forum US, Inc.

Copyright © FORUM ENERGY TECHNOLOGIES, INC. All rights reserved • PBV\_5312\_0624\_TBU