

# F300e Thrusters

## Technical Summary

• Power (Max)	30 kW
• Supply Voltage	600 Vdc
• Depth Rating	4000 msw
• Propellor Diameter	Ø300 mm
• Max Bollard Pull (Thrust)	360kg @ 1750 rpm
• Weight in air (Estimated)	46 kg
• Weight in water (Estimated)	28 kg
• Oil Compatibility	Mineral and EAL

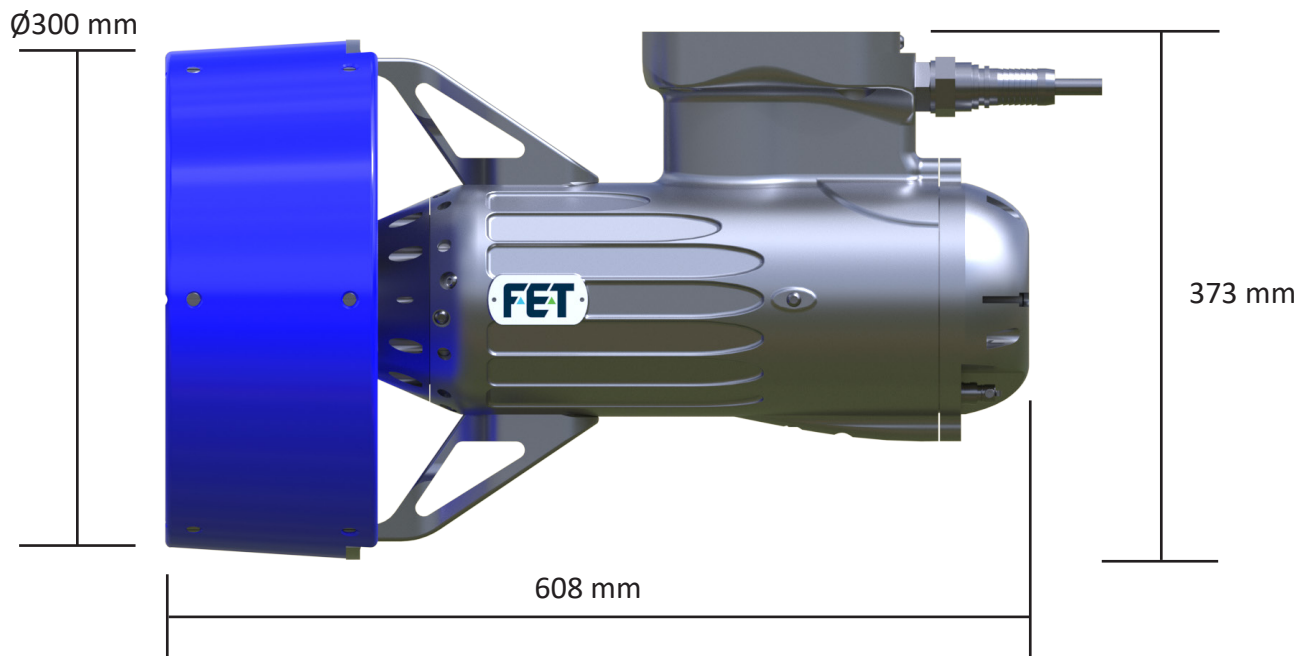
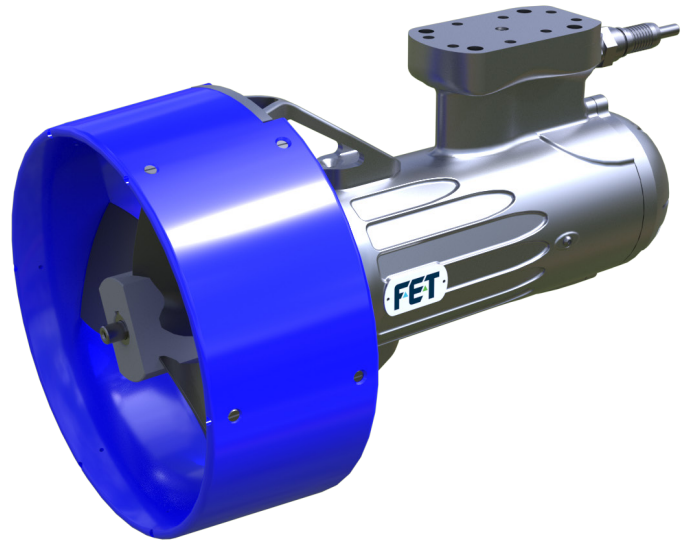

## Statorshield™ Technology equates to reliability

FET's Direct Drive Brushless DC Thruster incorporates the unique Statorshield™ Technology, which allows the thruster to continue running in the event of a shaft seal failure and subsequent flooding, without damage to the windings. The rotor and stator areas are oil filled and individually compensated.

# F300e Thrusters

## Innovative Shaft Sealing

The thruster also incorporates our proven ceramic wear ring technology used on all out current electric thrusters. The ceramic ring provides a durable hard surface that prevents wear to the shaft and the resultant seal and consequential flooding

## Advanced F-E-T Inverter (eThruster Controller JB) - System Features

- Unique Stator Shield Technology
- Continued Operation in the Event of Shaft Seal Failure
- Direct Drive Reliability (No Gearbox)
- Innovative Shaft Sealing
- Integral or External compensation available
- Easy in field bearing and seal replacement
- Range of connectors, oil filled hoses available
- Advanced F-E-T Inverter
  - Field Oriented (Vector) Control
  - Closed loop Speed or Current
  - Speed, Temperature, Voltage, Current & Vibration monitoring
  - Water leak detection
  - “Hours run” recording
  - Multi-drop RS485 Communications

## Typical ROV eThruster and Control System Architecture

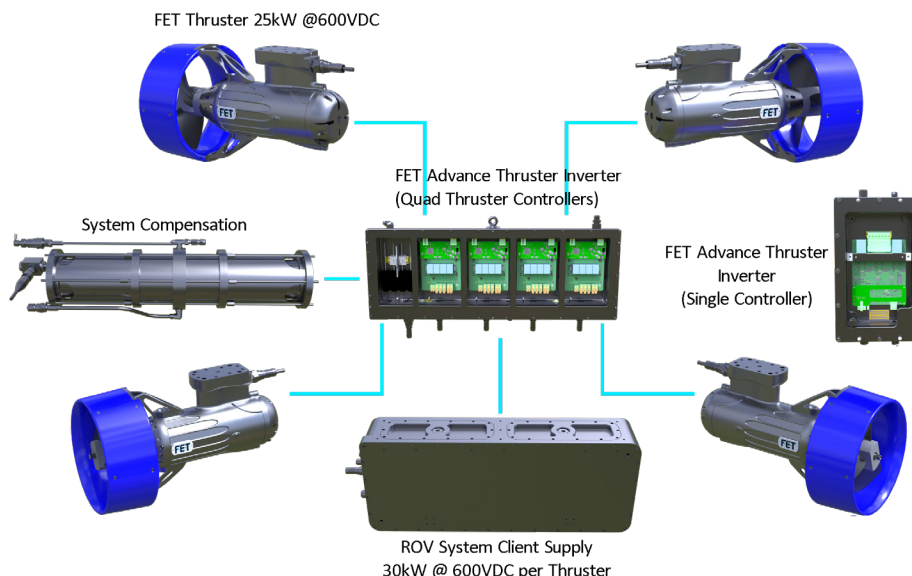

Contact Us:  
 Aberdeen: +44 (0) 1224 798660  
 Houston: +1 713 351 7900  
 Kirkbymoorside, York +44 (0) 1751 431751  
 Brazil: +55 22 3737 0690

The specification details are illustrative and are for marketing purposes only. Actual equipment may be different as a result of product improvement or other reasons. Specific interface and performance information should be reconfirmed at time of order placement.

SU1098.04.25